

TECHNICAL SPECIFICATIONS

| | | | |
|-------------------------|------------|---------------------------------|-----------------|
| - Height: | 427 mm | - Temperature after brewing: | 85 ± 3 °C |
| - Breath: | 200 mm | - Temperature after 30 minutes: | 82 ± 3 °C |
| - Depth: | 378 mm | - Temperature after 60 minutes: | 80 ± 3 °C |
| - Voltage: | 220-240 V~ | - Minimum brew volume: | 6 cups / 0.9 l |
| - Frequency: | 50 Hz | - Maximum volume per brew: | 12 cups / 1.8 l |
| - Total power: | 2075 W | - Brewing time per jug: | 5 min |
| - Power of boiler: | 2000 W | - Capacity per hour: | 134 cups / 20 l |
| - Power of PTC-element: | variable | - Water filling: | manual |
| - Number of hotplates: | 1 | | |

GENERAL

- The appliance must only be connected to an earthed plug socket.
- The appliance must never be submerged in water or rinsed under the tap.
- The appliance is fitted with a descaling warning system (red pilot light).
- The appliance is fitted with two temperature safeguards that can be reset.
- For this appliance use finely ground coffee and filter paper type 90/250.

INSTRUCTIONS FOR USE

- Place the filter paper and coffee in the filter basket (approx. 6 grams for each cup of 125 cc),
- Slide the filter basket back into the appliance,
- Place the glass jug on the hotplate,
- Fill the appliance with water equal to the amount of coffee to be made,
- Switch on the appliance (the light in the switch and the orange pilot light should now illuminate),
- Wait until the orange pilot light goes out,
- The coffee is ready and will be kept warm.

MAINTENANCE

- Wipe the outside of the appliance using a damp soft cloth, preferably with a soap-based cleaning agent (do not use a scouring agent!).
- Clean the filter basket and glass jug with washing-up liquid.
- The appliance must be descaled regularly (follow the instructions for the descaling agent).

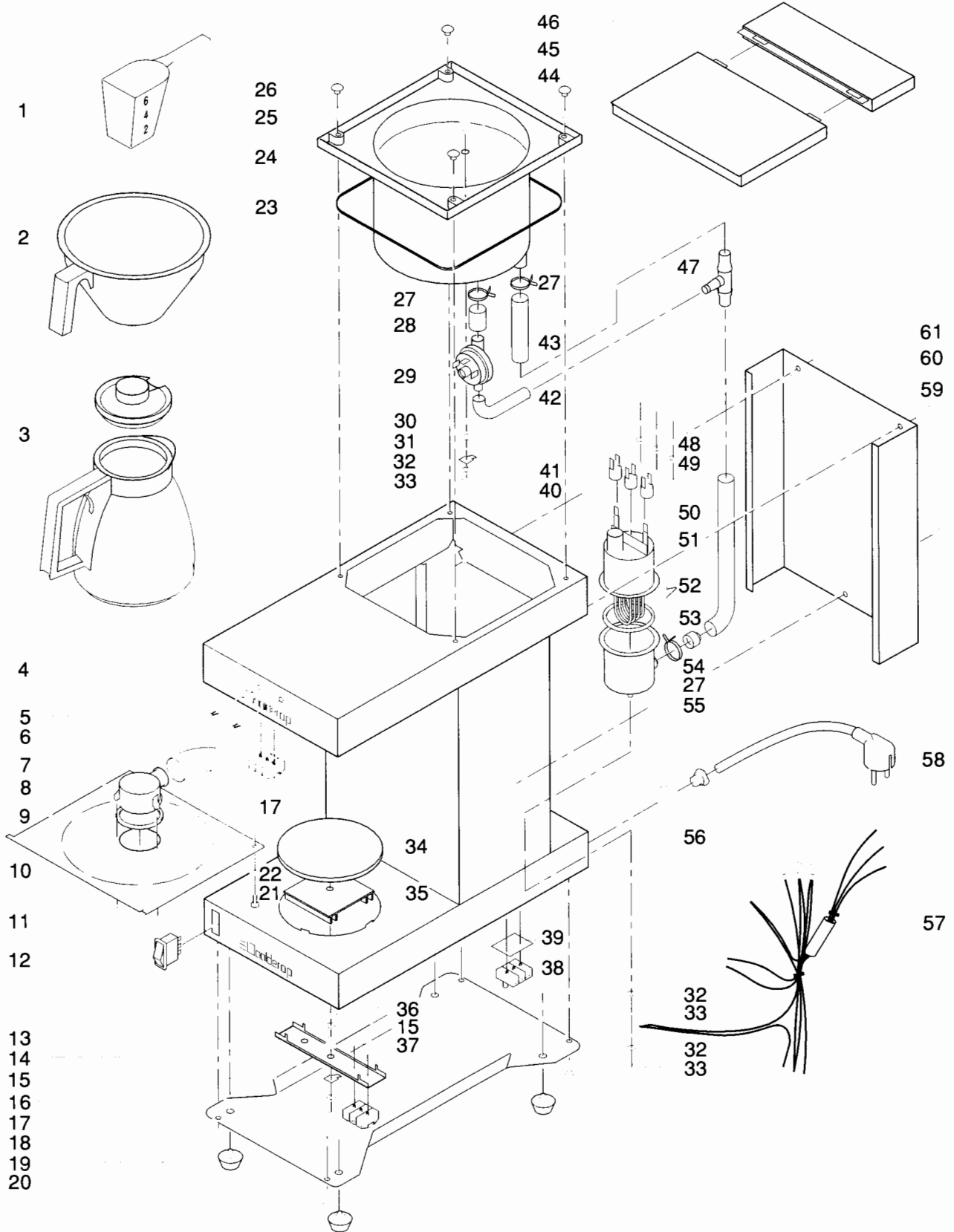

| Pos. | No. | Description | Article No. | Pos. | No. | Description | Article No. |
|------|-----|--|--------------|------|-----|--|------------------------------|
| 1 | 1 | Measuring scoop | 02.98.79.008 | *33 | 4 | Nut (M5) | 02.98.82.056 |
| 2 | 1 | Filter holder | 02.98.10.011 | 34 | 1 | Hotplate | 02.90.44.098 |
| 3 | 1 | Jug with cover | 02.98.40.023 | 35 | 1 | PTC-element | 02.98.70.100 |
| | | Cover for jug | 02.98.17.034 | *36 | 1 | Lock washer (4.4/12 mm) | 02.98.82.060 |
| 4 | 1 | Frame complete | | 37 | 1 | Nut (M4x8) | 02.98.82.062 |
| 5 | 1 | Pilot light (orange) | 67.72.01.002 | 38 | 1 | Terminal block | 68.31.31.003 |
| 6 | 1 | Pilot light (red) | 67.72.01.001 | 39 | 1 | Terminal block plate | 07.98.91.139 |
| 7 | 1 | Hose from boiler to spray head | 02.98.74.062 | 40 | 1 | Thermostat with bracket | 02.98.78.021 |
| 8 | 1 | Spray head | 02.98.22.015 | 41 | 2 | Temperature protection with bracket | 02.98.65.010 |
| 9 | 1 | O-ring for spray head | 02.98.83.074 | 42 | 1 | Hose from prestostat to T-piece | 02.98.74.065 |
| 10 | 1 | Support plate for spray head | 02.99.44.174 | 43 | 1 | Hose from tank to T-piece | 02.98.74.066 |
| *11 | 3 | Screw (No. 4x3/8") | 02.98.82.031 | 44 | 1 | O-ring (5x1.75 mm) | 83.34.17.109 |
| 12 | 1 | On/off switch (green) | 68.78.26.909 | *45 | 1 | Screw (M5x20) | 02.98.82.055 |
| 13 | 1 | Bracket for hotplate | 02.99.37.160 | 46 | 1 | Cover complete | 02.90.17.033 |
| 14 | 1 | Earth connector (M4/4.8x0.8) | 68.31.12.574 | 47 | 1 | T-piece | 02.98.46.013 |
| *15 | 2 | Spring washer (4.2 mm) | 82.74.52.014 | *48 | 3 | Nut (M3) | 82.48.03.112 |
| *16 | 1 | Nut (M4) | 82.48.03.114 | *49 | 3 | Spring washer (3.2 mm) | 82.74.53.012 |
| 17 | 2 | Terminal block | 68.31.31.014 | 50 | 1 | Hose from T-piece to boiler | 02.98.74.064 |
| *18 | 4 | Screw with spring washer (No. 6x3/8") | 02.98.82.022 | 51 | 1 | Boiler head with element Boiler complete with pos. 51, 52, 53 and 55 | 02.90.40.094 02.90.70.045 |
| 19 | 4 | Foot for base plate | 02.98.11.025 | 52 | 3 | Clamping spring for boiler | 02.98.77.027 |
| 20 | 1 | Base plate | 02.99.39.143 | 53 | 1 | O-ring for boiler | 83.34.32.060 |
| *21 | 2 | Screw (M4x8) | 82.02.05.093 | 54 | 1 | Non-return valve complete | 02.90.65.004 |
| *22 | 2 | Spring washer (4.3 mm) | 82.74.59.013 | 55 | 1 | Boiler foot | 02.90.40.093 |
| 23 | 1 | Seal for tank | 02.98.13.038 | 56 | 1 | Cable coupling | 68.36.35.308 |
| 24 | 1 | Tank | 02.98.05.008 | 57 | 1 | Wire tree with connectors | 02.98.66.180 |
| *25 | 4 | Screw (No. 6x3/8") | 02.98.82.071 | 58 | 1 | Mains plug with flex-cord | 02.98.68.038 |
| 26 | 4 | Screw cap for tank | 02.98.15.038 | 59 | 1 | Backplate | 02.99.22.034 |
| 27 | 3 | Hose clip | 74.47.72.720 | *60 | 3 | Screw with spring washer (M4x12) | 82.08.93.047 |
| 28 | 1 | Hose from tank to prestostat | 02.98.74.067 | *61 | 4 | Spacer ring (M4x2) | 82.73.30.013 |
| 29 | 1 | Prestostat | 64.06.01.024 | | | | |
| *30 | 1 | Lock washer (5.3 mm) | 82.74.07.114 | | | | |
| 31 | 1 | Earth connector (M5/6.3x0.8) | 68.31.12.828 | | | | |
| *32 | 3 | Spring washer (5.2 mm) | 82.74.51.015 | | | | |

* Standard stock items in trade distribution outlets

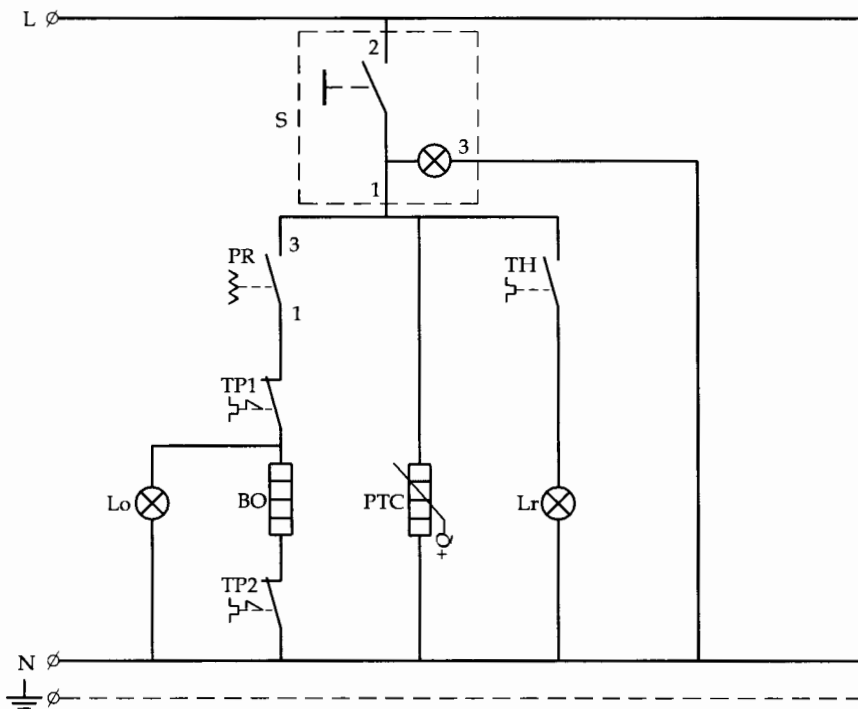

Electrical Diagram

- b = black
- bl = blue
- br = brown
- gy = green/yellow
- r = red
- w = white
- y = yellow

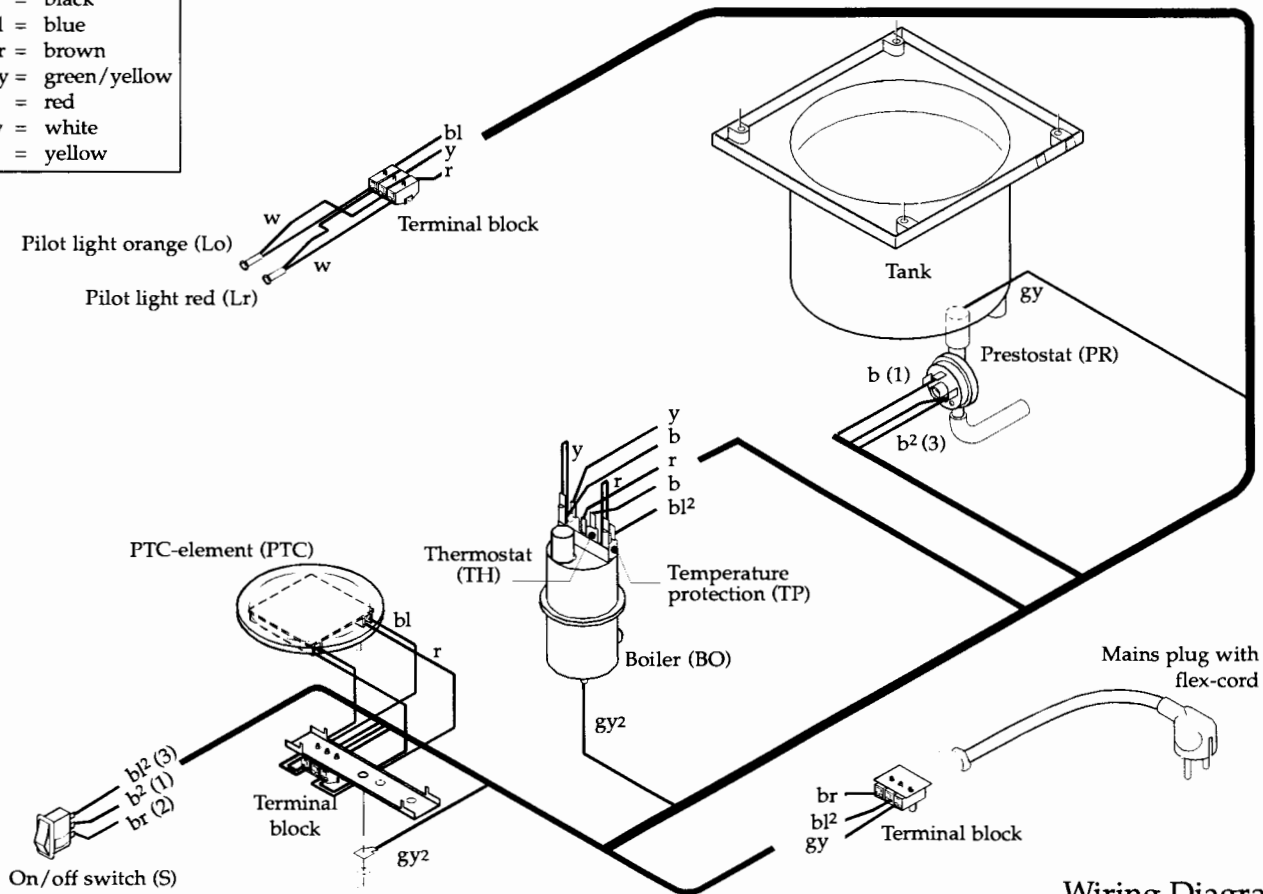

Wiring Diagram
www.daalderop.se